



For additional install
information please visit
www.p3gauges.com/install

F15C Install Guide



1 Remove side cover and air vent trim
with trim tool



2 Remove 3 7mm fasteners



3 Use a pry tool to move cluster bezel out
of the way, then slide the vent out



4a Remove the faceplate from the vent by
releasing the 7 tabs that secure it to the
vent with a flat pry tool

WARRANTY & LIABILITY:
Neither P3 Cars, nor its
dealers or agents shall be
liable in any way, for any
damage, loss, injury or other
claims, resulting from the
installation or use of this
product. By purchasing or
installing this product, you
assume all liability of any
kind connected with the use
and/or application of this
product. If you are unsure
that you can safely install and
use this product, consult a
qualified installer or
mechanic. The warranty on
this product covers only the
product itself for a period of 6
months from the date of
purchase, and it will be at our
discretion to repair or replace
the affected parts. No user
serviceable parts inside.
Warranty will be voided if
product shows physical
damage.



4b



4c



For additional install
information please visit
www.p3gauges.com/install

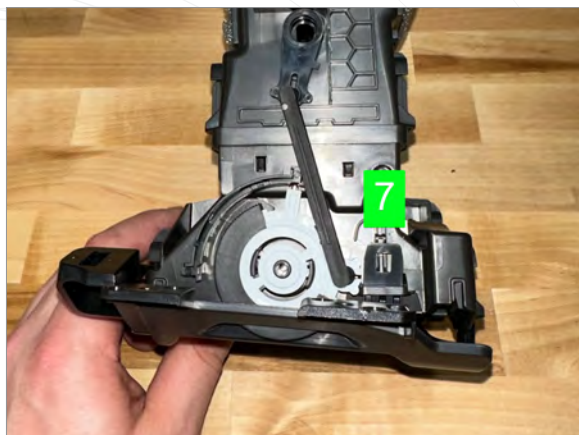

4d

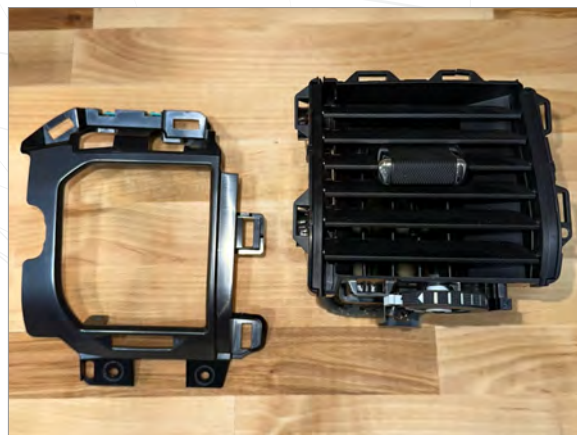

4e



5a Remove horizontal slat assembly
and then remove two upper slats.



5b Install display into horizontal slat
assembly

WARRANTY & LIABILITY:
Neither P3 Cars, nor its
dealers or agents shall be
liable in any way, for any
damage, loss, injury or other
claims, resulting from the
installation or use of this
product. By purchasing or
installing this product, you
assume all liability of any
kind connected with the use
and/or application of this
product. If you are unsure
that you can safely install and
use this product, consult a
qualified installer or
mechanic. The warranty on
this product covers only the
product itself for a period of 6
months from the date of
purchase, and it will be at our
discretion to repair or replace
the affected parts. No user
serviceable parts inside.
Warranty will be voided if
product shows physical
damage.



6 Feed the display cable through the vent
housing as shown (Be sure to keep cable
flat on left side of vent housing)



7 Align slider fork on center slat



For additional install
information please visit
www.p3gauges.com/install



8 Fold display cable around back of vent
and close air flap to hold it in place



9 Reinstall trim onto vent housing



10 Feed display cable through dash
and to plug into control box. Plug
control box into OBD2 connector
and tuck in lower dash.



Installation complete. Enjoy your gauge.

WARRANTY & LIABILITY:
Neither P3 Cars, nor its
dealers or agents shall be
liable in any way, for any
damage, loss, injury or other
claims, resulting from the
installation or use of this
product. By purchasing or
installing this product, you
assume all liability of any
kind connected with the use
and/or application of this
product. If you are unsure
that you can safely install and
use this product, consult a
qualified installer or
mechanic. The warranty on
this product covers only the
product itself for a period of 6
months from the date of
purchase, and it will be at our
discretion to repair or replace
the affected parts. No user
serviceable parts inside.
Warranty will be voided if
product shows physical
damage.